

EXCEPT AS OTHERWISE PROVIDED BY CONTRACT, THIS DRAWING AND SPECIFICATIONS SHALL NOT BE REPRODUCED, COPIED OR USED AS THE BASIS FOR MANUFACTURE OR SALE OF MATTER DEPICTED HEREIN WITHOUT THE EXPRESSED WRITTEN PERMISSION OF THE CLAUDE LAVAL CORPORATION, OR ITS ASSIGNEES.

NOTES:

1. INLET & OUTLET FLANGES ARE 10" 150# RF PER ANSI B16.5 REQUIRING 12X  $\phi 7/8"$  BOLTS (BOLTS AND GASKETS NOT INCLUDED).
2. MAXIMUM PRESSURE: 150 psi (10.3 bar).
3. MAXIMUM TEMPERATURE: 180°F (82.2°C).
4. PRESSURE LOSS: 3-12 psid (.2-.8 bar) AT RATED FLOW.
5. RATED FLOW: 1850-3400 gpm (420-775 m<sup>3</sup>/hr).
6. APPROXIMATE DRY WEIGHT: 2779 lbs (1263 kg).
7. APPROXIMATE OPERATIONAL WEIGHT: 4196 lbs (1903 kg).
8. FINISH: POWDERCOAT LAKOS BLUE (EXTERIOR ONLY) SCOTCHKOTE 134 (INTERNAL WETTED SURFACES).

REVISION HISTORY				
ZONE	REV	DESCRIPTION	DATE	APPROVED
	A	ADD CENTER OF MASS AND APPROXIMATE OPERATIONAL WEIGHT	9/7/18	AMF
	B	UPDATED TO CURRENT STANDARDS	1/21/2020	TPF

THIS DRAWING HAS BEEN GENERATED AND IS MAINTAINED BY A CAD SYSTEM. CHANGES SHALL ONLY BE INCORPORATED AS DIRECTED BY AN APPROVED ENGINEERING CHANGE ORDER (ECO). PAPER COPIES ARE UNCONTROLLED.

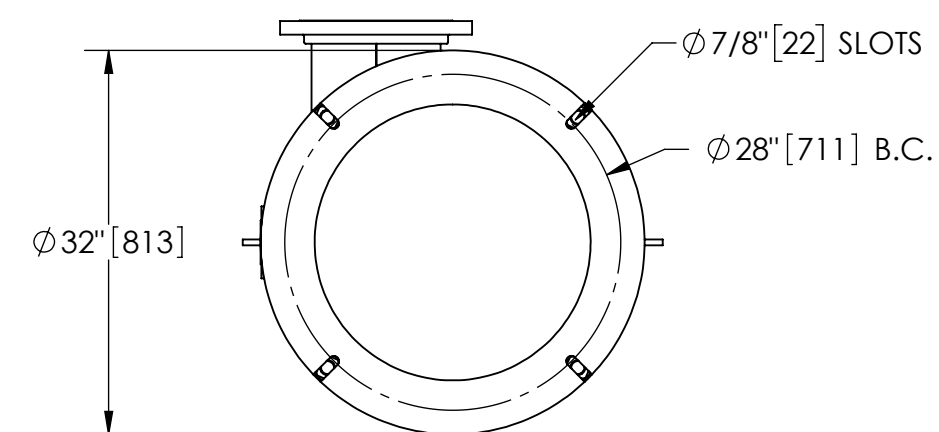
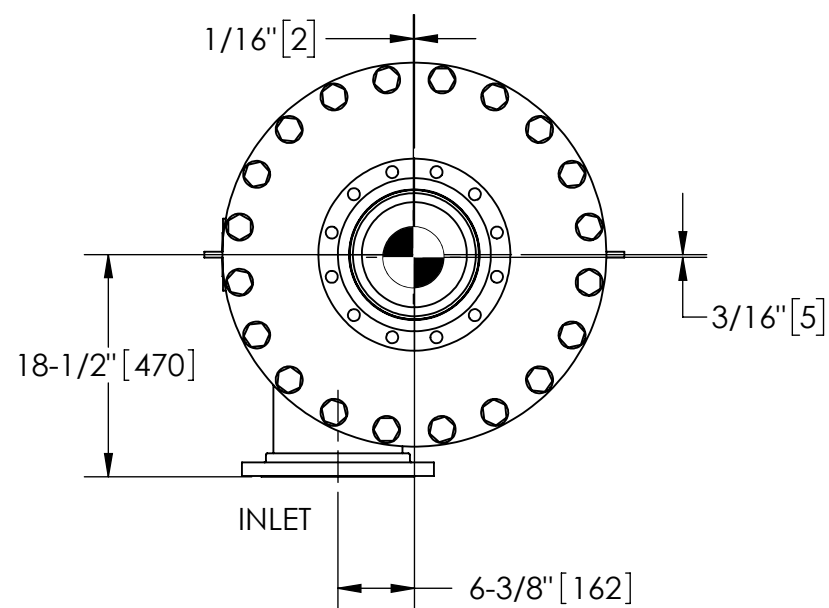

**BOTTOM VIEW**

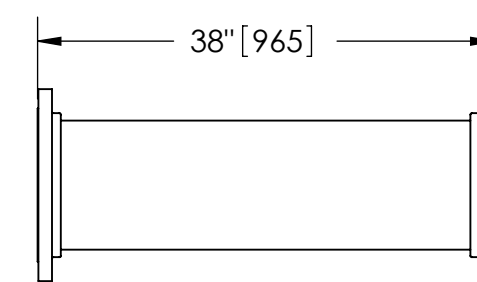

**FLANGED SPOOL**  
MODEL FS-10/SK (AVAILABLE SEPARATELY)  
REQUIRED FOR REMOVAL OF TOP ASSEMBLY

**SUBMITTAL DRAWING**

This drawing is submitted for spatial consideration only. Do not pre-plumb to these dimensions.

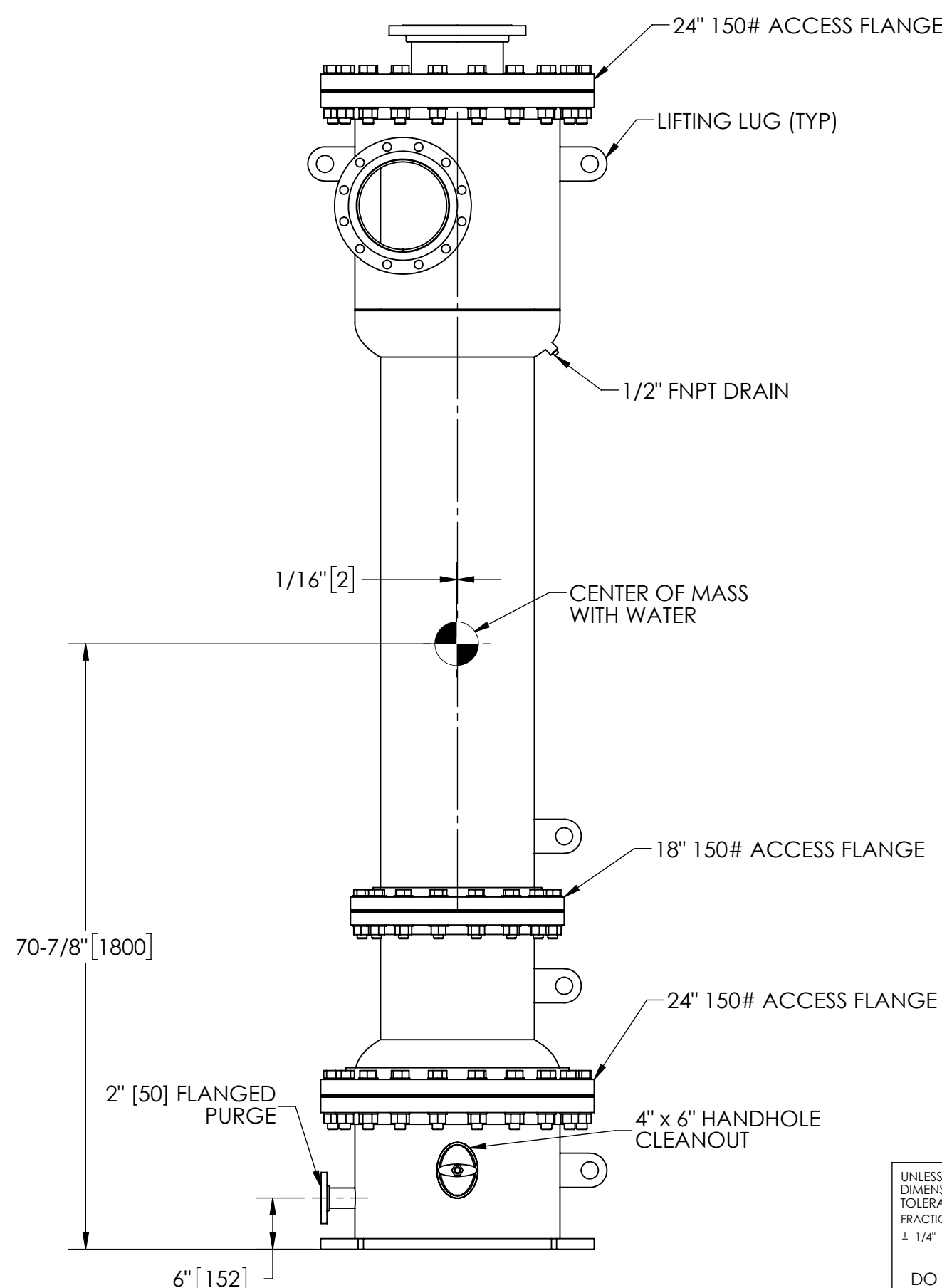
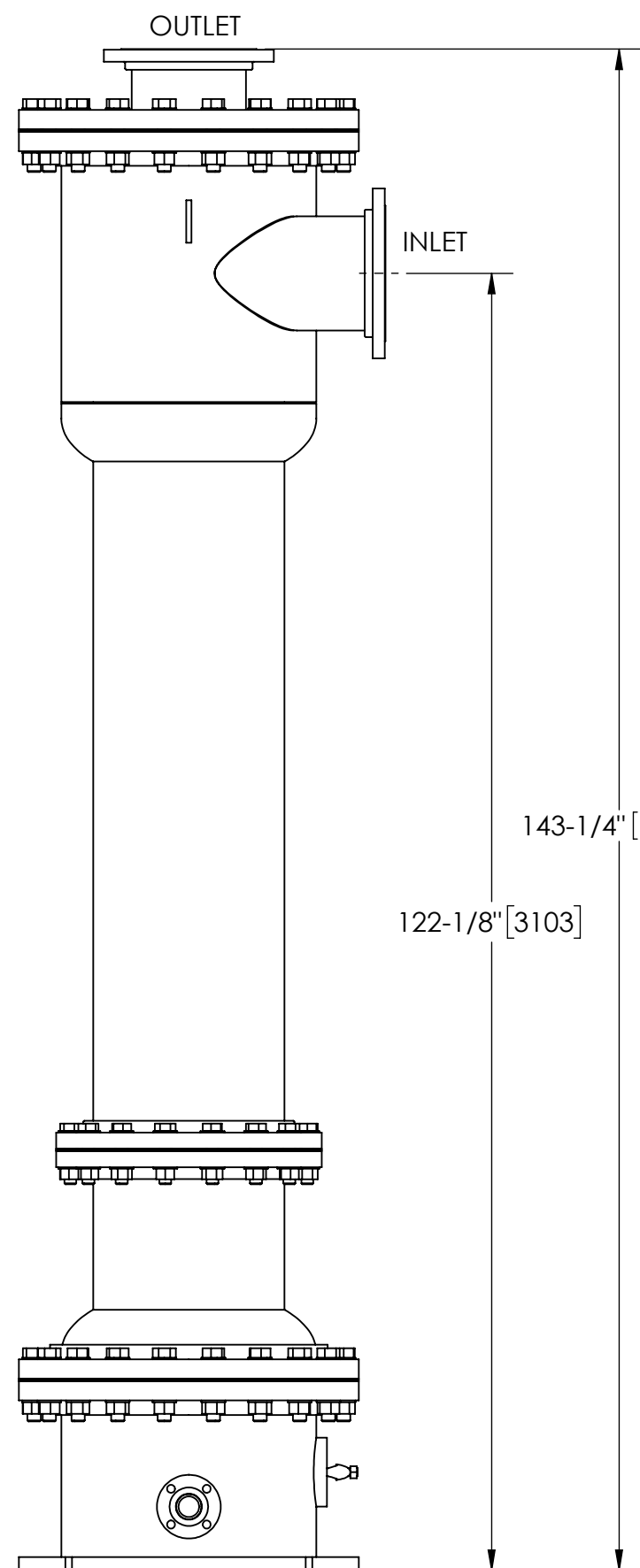

UNLESS OTHERWISE SPECIFIED:  
DIMENSIONS ARE IN: INCHES (mm)  
TOLERANCES ARE:

FRACTIONS	DECIMALS	ANGLES
$\pm 1/4"$	.XX $\pm .01$	$\pm 1/4^\circ$
	.XXX $\pm .005$	
	.XXXX $\pm .0005$	

DO NOT SCALE DRAWING

ENGINEERED FOR:	
STANDARD	
APPROVALS	DATE
DRAWN DLW	3/9/07
ENGR DLW	3/9/07
MFG -	-
WORK ORDER	QTY.

<b>LAKOS</b>		CLAUDE LAVAL CORP. FRESNO, CALIFORNIA 93727 WWW.LAKOS.COM	
TITLE JSK-1850-V, SEPARATOR, 1850-3400 gpm, CARBON STEEL/SCOTCHKOTE			
SIZE C	MODEL NO.	DWG NO. 127682	REV. B
SCALE 1:16	EST. WT. 4196 lb	SHEET 1 OF 1	

DWG NO.

127682

SHT

REV. B

A