

4

3

2

1

EXCEPT AS OTHERWISE PROVIDED BY CONTRACT, THIS DRAWING AND SPECIFICATIONS SHALL NOT BE REPRODUCED, COPIED OR USED AS THE BASIS FOR MANUFACTURE OR SALE OF MATTER DEPICTED HEREIN WITHOUT THE EXPRESSED WRITTEN PERMISSION OF THE LAKOS CORPORATION, OR ITS ASSIGNEES.

THIS DRAWING HAS BEEN GENERATED AND IS MAINTAINED BY A CAD SYSTEM. CHANGES SHALL ONLY BE INCORPORATED AS DIRECTED BY AN APPROVED ENGINEERING CHANGE ORDER (ECO). PAPER COPIES ARE UNCONTROLLED.

REVISION HISTORY				
ZONE	REV	DESCRIPTION	DATE	APPROVED
	A	RELEASE FOR PRODUCTION	8/12/13	JB
	B	UPDATE TO NEW STANDARDS	11/13/2019	TRR

NOTES:

1. INLET & OUTLET FLANGES ARE 8" 150# RF PER ANSI B16.5 REQUIRING 8X ϕ 3/4" BOLTS (BOLTS AND GASKETS NOT INCLUDED).
2. MAXIMUM PRESSURE: 150 psi (10.3 bar).
3. FOR MAXIMUM TEMPERATURE, CONSULT FACTORY.
4. PRESSURE LOSS: 3-12 psid (.2-.8 bar) AT RATED FLOW.
5. RATED FLOW: 1160-2150 gpm (265-490 m³/hr).
6. APPROXIMATE DRY WEIGHT: 1876 lbs (851 kg).
7. FINISH: POWDERCOAT LAKOS BLUE (EXTERIOR ONLY) SCOTCHKOTE 134 (INTERNAL WETTED SURFACES).

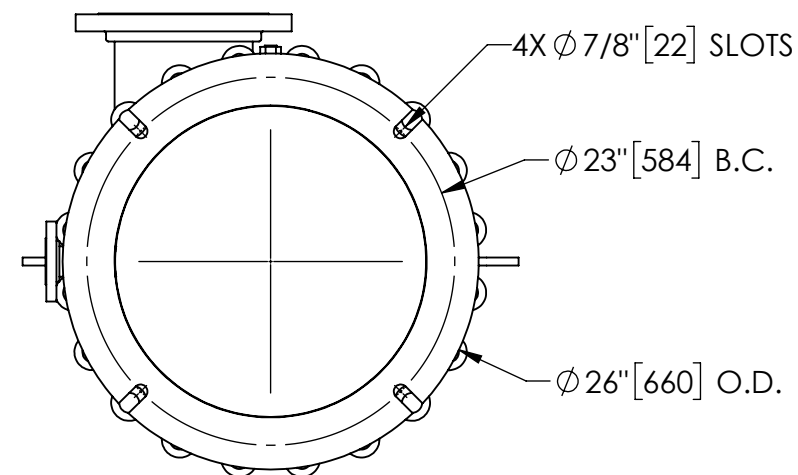
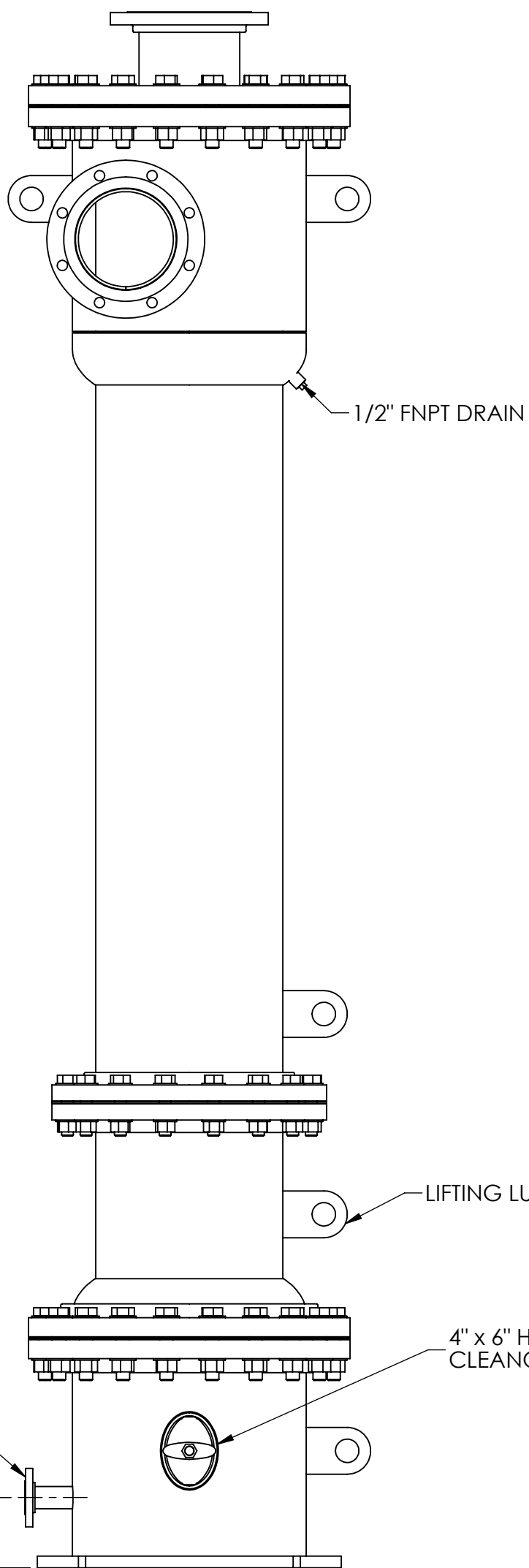
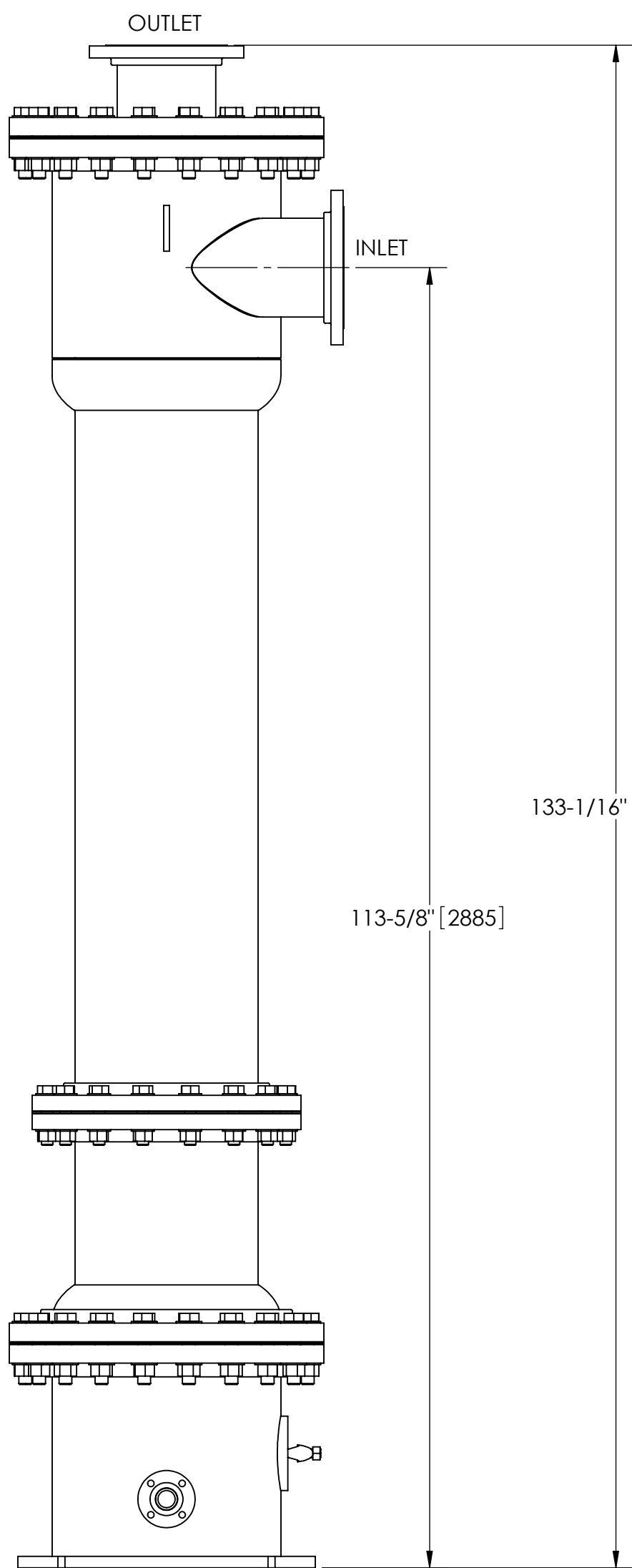
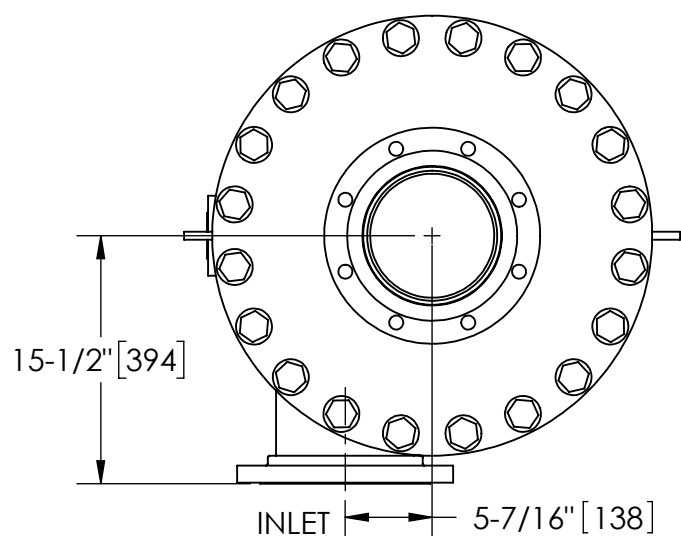

BOTTOM VIEW

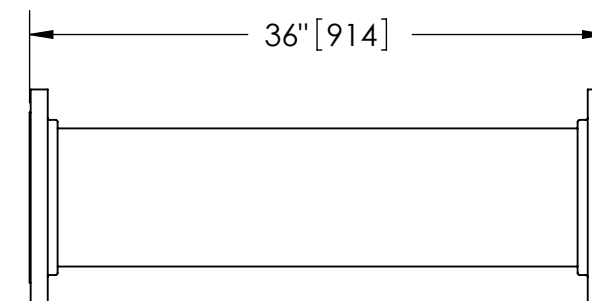

FLANGED SPOOL
 MODEL FS-08/SK (AVAILABLE SEPARATELY)
 REQUIRED FOR REMOVAL OF TOP ASSEMBLY

SUBMITTAL DRAWING

This drawing is submitted for spatial consideration only. Do not pre-plumb to these dimensions.

UNLESS OTHERWISE SPECIFIED: DIMENSIONS ARE IN: INCHES (mm) TOLERANCES ARE: FRACTIONS .XX ± .01 ANGLES ± 1/4° DECIMALS .XXX ± .005 ANGLES .XXX ± .0005			ENGINEERED FOR: STANDARD			
DO NOT SCALE DRAWING			APPROVALS	DATE	TITLE	
MATERIAL CLASS P-1 MILD CARBON STEEL			DLW	2/9/07	JSK-1160-V, SEPARATOR, 8" JSK VERTICAL, CARBON STEEL/SCOTCHKOTE	
FINISH SEE NOTES			ENGR	DLW	2/9/07	SIZE MODEL NO. DWG NO. 120572
			REVIEW	-	-	EST. WT. 1885 lb SHEET 1 OF 1
			WORK ORDER		QTY.	SCALE 1:12

4

3

2

1

DWG NO. 120572
 SH 1
 REV B